

Im.PAc.T

SB45-00

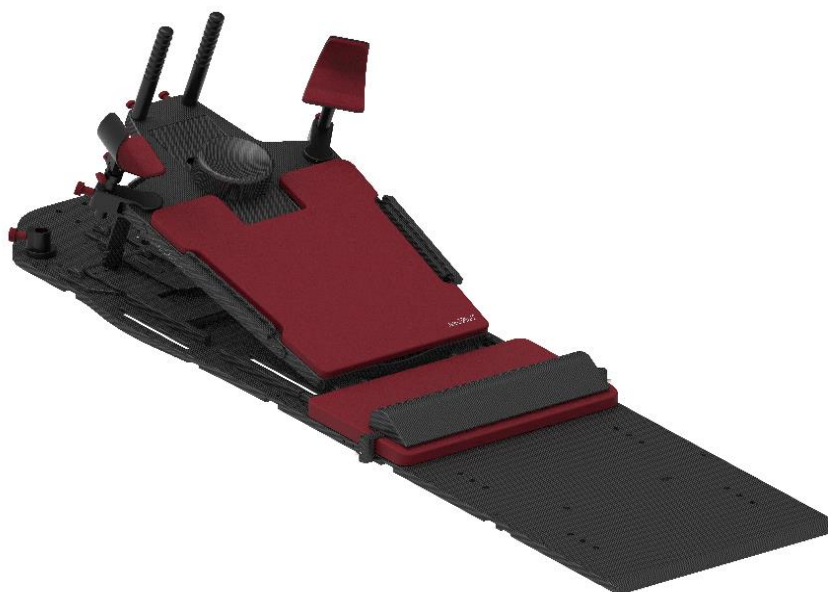

SIGMA BOARD – AIO

Panacea Medical Technologies Pvt Ltd

Doc no: PMT-PA1-01-45-08-19-R00

Table of Contents

1 INTENDED USE AND INDICATIONS FOR USE 3

1.1 INTENDED USE.....3

1.2 INDICATION FOR USE3

2. PRODUCT OVERVIEW 3

3. ASSEMBLING INSTRUCTIONS 4

3.1 Placement of Indexing bar 5

3.2 Compatible headrests & Accessories.....6

3.3 Compatible mask.....7

4 TECHNICAL SPECIFICATIONS 8

5 CLEANING, STORAGE AND DISPOSAL 8

1 INTENDED USE AND INDICATIONS FOR USE

1.1 INTENDED USE

The Sigma Board is intended for immobilizing patients across a wide range of radiotherapy treatment sites to cover all anatomical regions. It supports customizable, head-to-toe positioning for precise and consistent treatment delivery

1.2 INDICATION FOR USE

The Sigma Board is indicated for use in external beam radiotherapy to position and immobilize patients in supine or prone orientations. It is suitable for treatments involving the head, neck, thorax, abdomen, pelvis, and extremities. The system accommodates various modular accessories such as headrests, knee & arm supports. It is designed to improve setup reproducibility, enhance patient comfort, and optimize clinical workflow. It is also used during image acquisition for treatment planning on a CT unit or simulator.

2. PRODUCT OVERVIEW

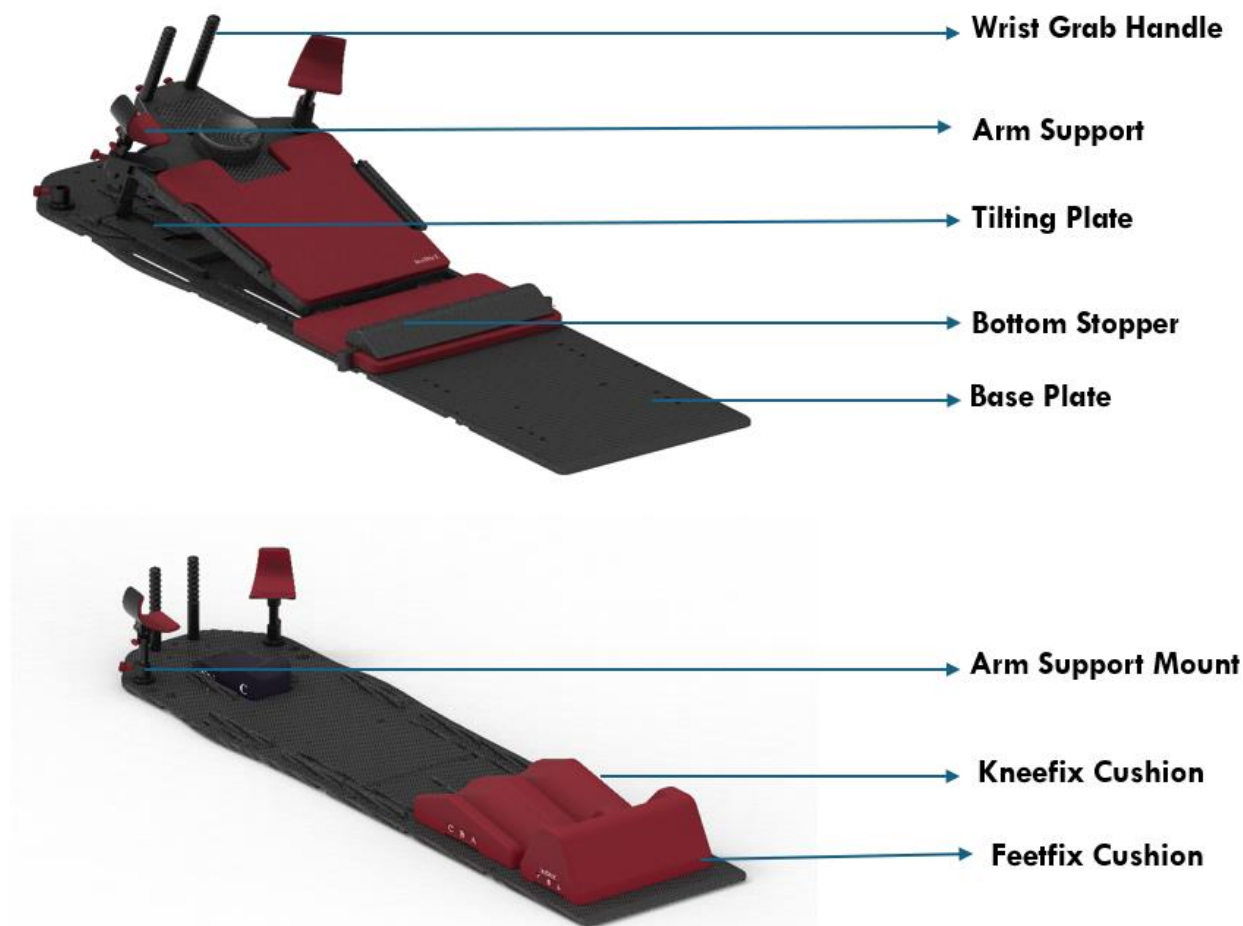

Figure 1 Sigma Board – AIO



Warning

- Inspect the device thoroughly before use. Do not use the device if damaged.
- Prevent the surface from damage and scratching.
- Secure the device properly before positioning the patient.

3. ASSEMBLING INSTRUCTIONS

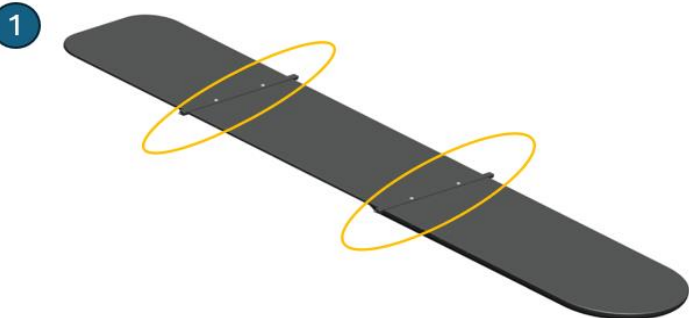

Indexing bar Placement



Sigma board AIO Placement on the indexing bar



Tilting plate Placement

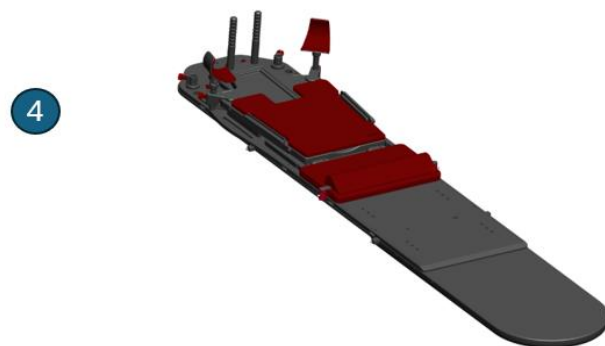

Breast board fixing with Accessories

Figure 2 Assembling Instructions

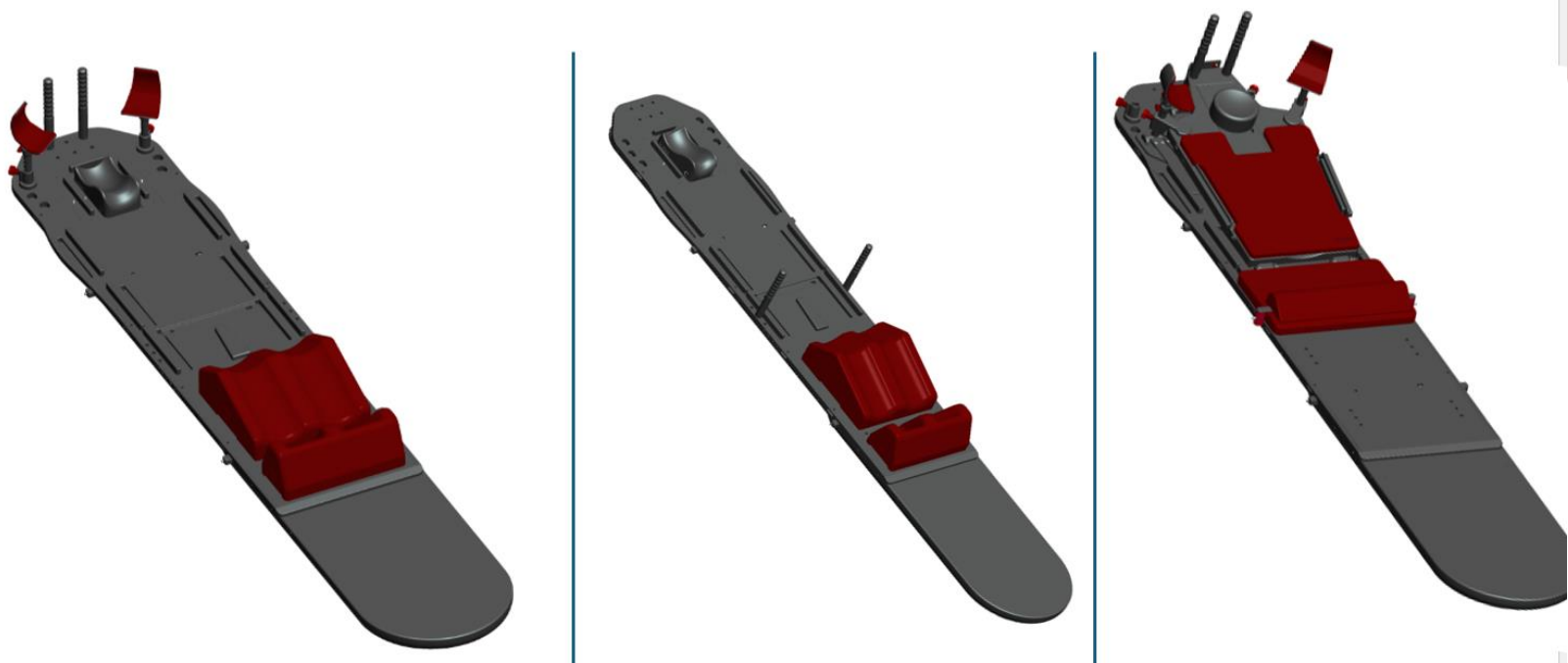

Figure 3 Variant Assemblies

3.1 Placement of Indexing bar

Step 1: Place 2-indexing bars on the Couch Top and make sure that it has been fixed properly in the slots.

Step 2: Position the sigma board above the indexing bars and movement should not be there in baseplate.

Step 3: Place the suitable headrest and other accessories required, fix the knee fix cushion and Feet fix cushion using the kneefix indexing bar according to the patient's height and place the knee fix & feet fix onto slots A, B, or C with K1, K2, F1 & F2 positions and if further height adjustment is needed, utilize the Kneefix elevation block.

Step 4: Based on the treatment setup, a Breast tilting board can be utilized for breast case treatments with the fixture of tilting indexing bar and arm support can be directly used on the main base plate assembly and breast board. And the wrist grab handle can be fixed at three positions, on the breast board, the top of the main base plate board and at the pelvic region of base plate, depending on patient comfort and clinical requirements.



3.2 Compatible headrests & Accessories



Carbon fiber headrests

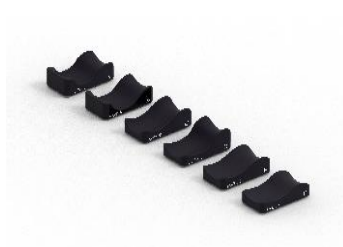

Foam headrests



Posease headrests

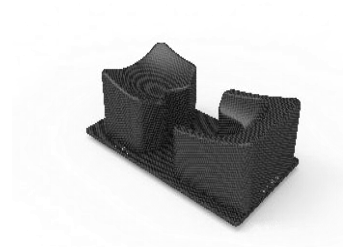

Prone headrests

- Assemble the other necessary devices (If required)
- Wedges for head angulation at 5°, 10°, and 15° to ensure accurate patient positioning during procedures. For patient comfort and height adjustment, elevation blocks are available in 20 mm and 40 mm sizes.
- Utilize the pediatric headrest with adapter for pediatric patient.
- Position the patient and fix the Clamp type thermoplastic mask with mask locking cushions to immobilize.

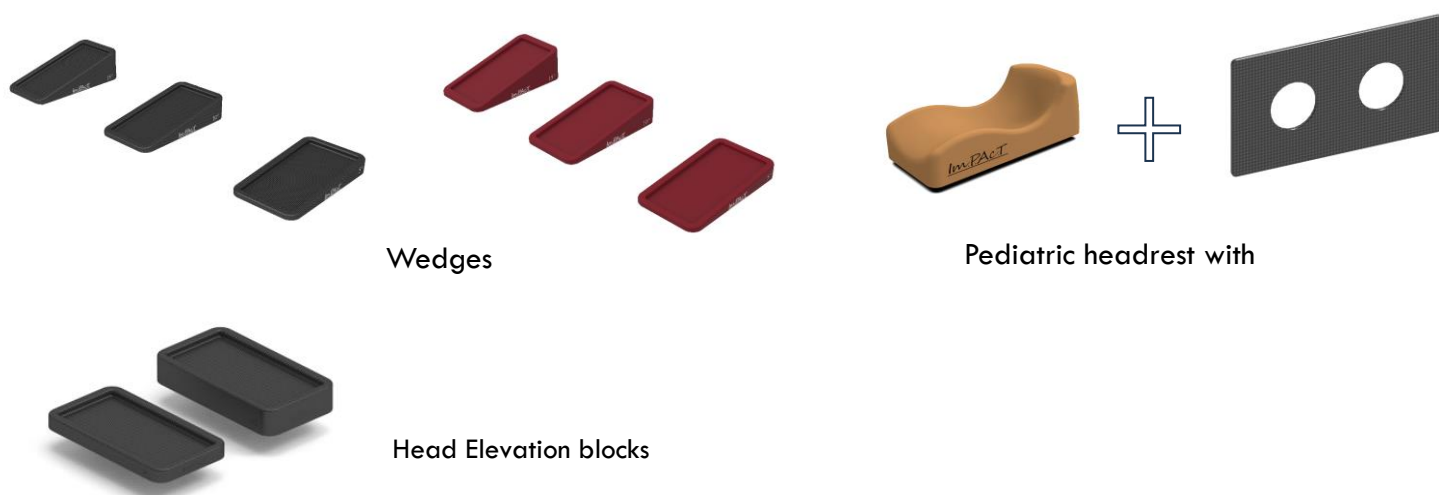

3.3 Compatible mask

S.no	Mask type
1	Head mask – 3 Points
2	Neck and shoulder mask – 4 Points
3	Head and shoulder mask - 5 Points
4	Chest and pelvic mask – 4 Points
5	Pelvic mask – 6 Points
6	Breast mask

4 TECHNICAL SPECIFICATIONS

1	Material	Carbon fiber
2	Weight	~ 23 kg (With all accessories)
3	Weight bearing capacity	120kg

5 CLEANING, STORAGE AND DISPOSAL

- Keep out of direct sunlight and warm, humid environments. Use a cleaning solution such as 15-20% diluted isopropyl alcohol to give it a thorough cleaning. Before using again, let it dry.
- Keep each thermoplastic mask labelled with the patient's ID. Masks can be reused for the same patient's subsequent treatment cycle.
- The product may be disposed of with dry trash; the mask can be reused in accordance with the treatment plan and cycle.
- Examine the product frequently to see if any parts need to be replaced or repaired since they may be worn out.

Panacea Medical Technologies Pvt Ltd

Plot #35, Malur KIADB Industrial Area,

4th Phase, Malur – 563130, Kolar District,

Karnataka, INDIA.

Website : <http://www.panaceamedical.com>,

Email : support@panaceamedical.com

